

ANSI B16.5 CLASS #300 NECK FLANGE

Material	steel ASTM A105WCB
Pressure	ANSI #300

TECHNICAL DESCRIPTION

Neck (skirt) flanges according to the ANSI B16.5 / Class #300 standard are pipeline elements that are widely used in the construction of steel pipelines and pipe segments (spools) used in industry, industry, shipbuilding and ship repair.

They are easily distinguished from flat flanges by the long conical neck, which gradually transitions to a pipe or other fitting connected by butt welding. The conical neck provides a smooth transition to the diameter of the pipe, which reduces internal stresses in the material. The latter makes them very suitable for applications with elevated or lowered temperatures, as well as those with sharp mechanical or thermal fluctuations. The inner diameter is shaped to match the diameter of the pipe, which reduces fluid resistance, as well as corrosion and wear from friction of the passing fluid.

We stock ANSI B16.5 / class #150 and #300 steel flanges, but can supply flanges up to class #2500, in a variety of materials. We have the necessary machining equipment, which allows us to also offer flanges with sealing surfaces.

- sealing surface type A, B2, C, D, E, F
- non-standard sealing surfaces on request
- profile grooves for metal sealing rings (segments) type RTJ
- threaded type flanges
- flanges made to customer specifications, and others.

SUPPORTED MATERIALS IN STOCK:

- Carbon steel ASTM A105 WCB

Dimensions: 1/2" - 24"

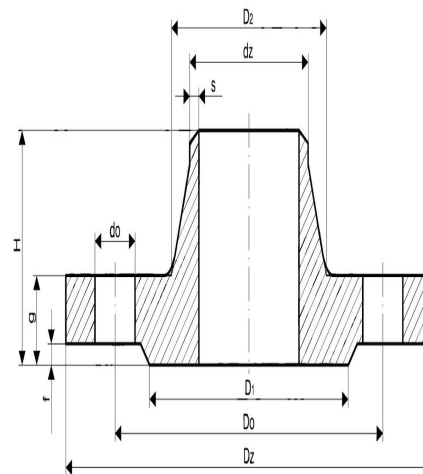

ANSI B16.5 CLASS #300 NECK FLANGE

Material steel ASTM A105WCB
Pressure ANSI #300

No.	DETAILS	MATERIALS	STANDARD
1	FLANGE NECK (SKIRT) ANSI B16.5 / #150	steel A105 WCB (1.0432)	ASTM A 695-95
	other steels - on request		
		ASTM A105N; C22.8 (1.0460)	ASTM
		ASTM/ASME A182 F1-F12-F11	ASTM A 182-02
	other stainless steels - on request		
		Stainless Steel - ASTM A182 F304 - 304L	ASTM
		Stainless steel - AISI A182 F316 - F316L	ASTM
		Low temperature grades/alloys - ASTM A352 LF2	ASTM
		High strength steels - ASTM A694 F42; F52	ASTM

SPECIFICATION	
Standard	ANSI B16.5
Pressure	#300 (PN 50)
Sealing surface	flat face (FF)
Guidance surface options	with flange (RF) or profile channel (RTJ)

ANSI B16.5 CLASS #300 NECK FLANGE

Material steel ASTM A105WCB
Pressure ANSI #300

DN	pipe Ø	flange dimensions										open
	dz	Dz	Do	do	H	g	d2	S	D	f	Kg	n
1/2"	21.3	95.2	66.5	15.7	52.3	14.2	38.1	2.80	35.0	1.6	0.75	4
3/4"	26.7	117.3	82.5	19.0	57.1	15.7	47.7	2.95	42.9	1.6	1.26	4
1"	33.5	123.9	88.9	19.0	62.0	17.5	53.8	3.40	50.8	1.6	1.52	4
1 1/4"	42.2	133.3	98.5	19.0	65.0	19.0	63.5	3.55	63.5	1.6	2.03	4
1 1/2"	48.3	155.4	114.3	22.3	68.3	20.6	69.8	3.70	73.1	1.6	2.89	4
2"	60.3	165.1	127.0	19.0	69.8	22.3	84.0	3.90	91.9	1.6	3.4	8
2 1/2"	73.2	190.5	149.3	22.3	76.2	25.4	100.0	5.20	104.6	1.6	5.17	8
3"	88.9	209.5	168.1	22.3	79.2	28.4	117.3	5.45	127.0	1.6	6.93	8
3 1/2"	101.6	228.6	184.1	22.3	81.0	30.2	133.3	5.70	139.7	1.6	8.67	8
4"	114.3	254.0	200.1	22.3	85.8	31.7	146.0	5.95	157.2	1.6	11.2	8
5"	141.2	279.4	234.9	22.3	98.5	35.0	177.8	6.45	185.6	1.6	15.1	8
6"	168.3	317.5	269.7	22.3	98.5	36.5	206.2	7.10	215.9	1.6	19.1	12
8"	219.1	381.0	330.2	25.4	111.2	41.1	260.3	8.25	269.7	1.6	29.9	12
10"	273.1	444.5	387.3	28.4	117.3	47.7	320.5	9.25	323.8	1.6	42.7	16
12"	323.9	520.7	450.8	31.7	130.0	50.8	374.6	9.50	381.0	1.6	61.8	16
14"	355.6	584.2	514.3	31.7	142.7	53.8	425.4	*	412.7	1.6	85.8	20
16"	406.4	647.7	571.5	35.0	146.0	57.1	482.6	*	469.9	1.6	106	20
18"	457.2	711.2	628.6	35.0	158.7	60.4	533.4	*	533.4	1.6	131	24
20"	508.0	774.7	685.8	35.0	162.0	63.5	587.2	*	584.2	1.6	158	24
24"	609.6	914.4	812.8	41.1	168.1	69.8	701.5	*	692.1	1.6	230	24

*) Upon agreement with the manufacturer